

Lyme Way

KNOWLE

APPROXIMATE FLOOR AREA
87.1 SQM / 937 SQFT



GROUND FLOOR
475 sq.ft. (44.2 sq.m.) approx.

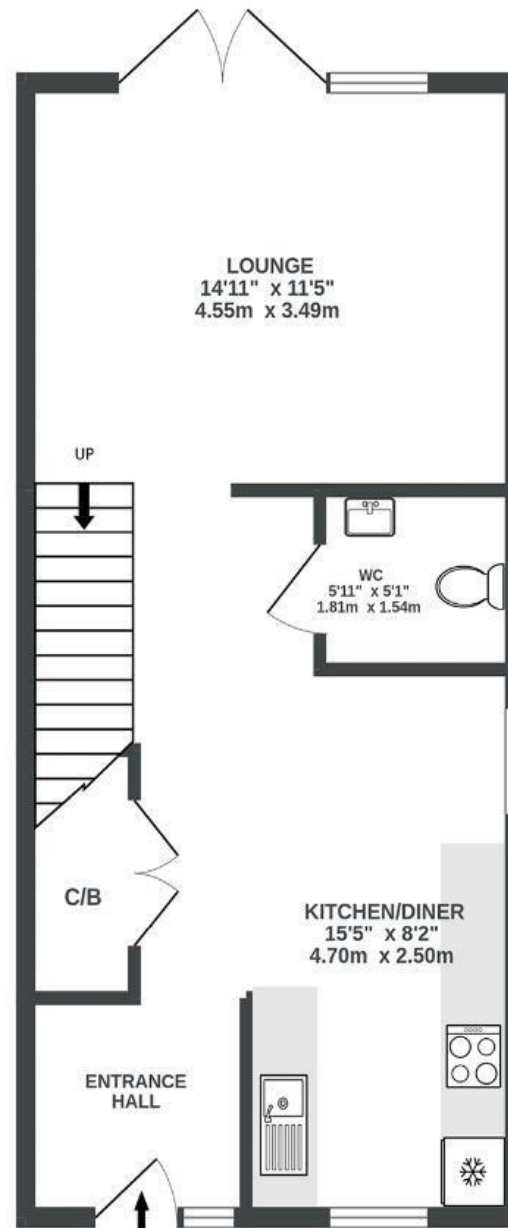

1ST FLOOR
462 sq.ft. (42.9 sq.m.) approx.

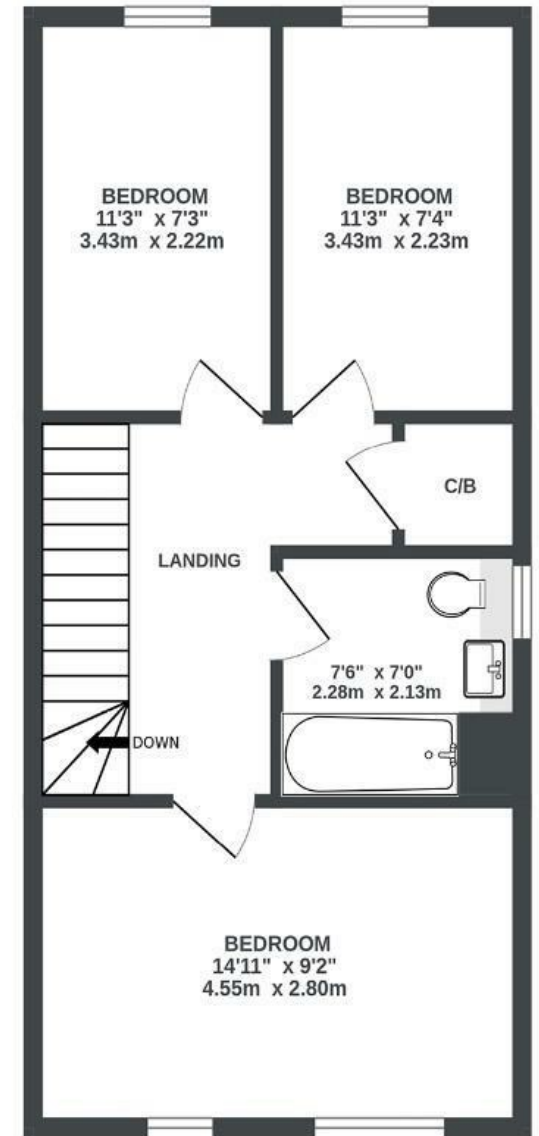

Illustrations are for reference purposes only, measurements are approximate, not to scale.

Boardwalk

Lyme Way

KNOWLE, BRISTOL



£335,000



BS4 1FY



3 Bedrooms



2 Bathrooms

"We really enjoy living here. The house has a clean, Scandinavian style — it's eco-friendly, well thought-out, and everything feels solid and built to last. The design just makes sense. There's a great sense of community, our neighbours are friendly, and it feels safe and settled. It's also super convenient — really easy access to central Bristol, and we're right near a beautiful nature reserve, which is a real bonus. It's a place that works for all kinds of people."

